

# THE NEW PALAFOX

## CONCEPTUAL DESIGN

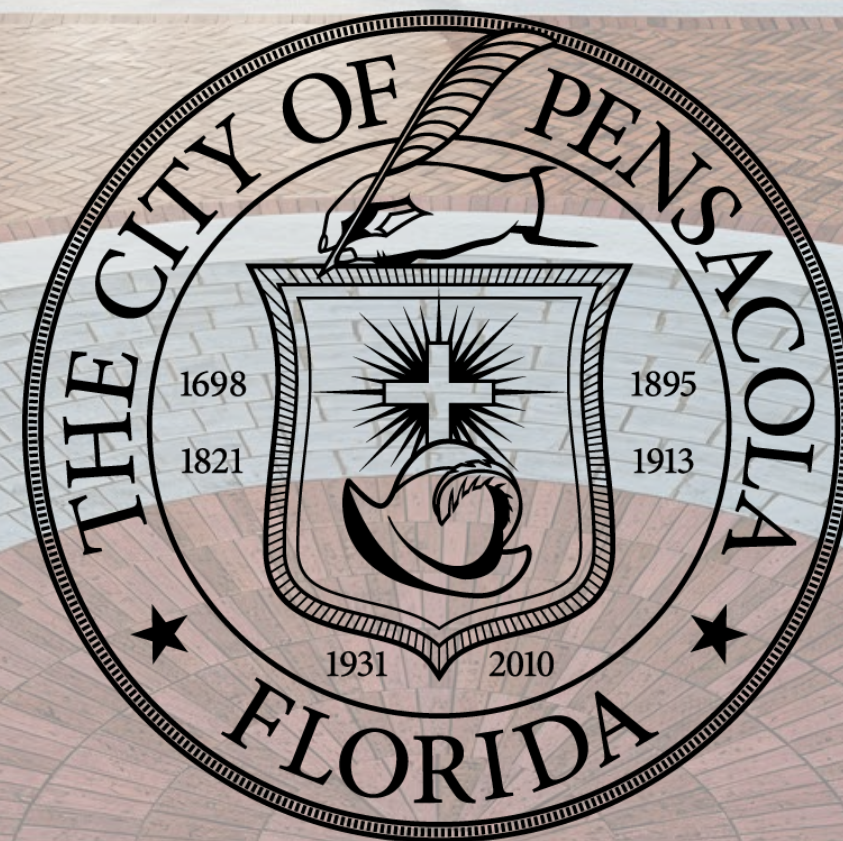

PENSACOLA, FLORIDA



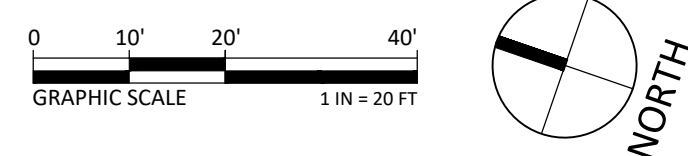

## THE NEW PALAFOX - CONCEPTUAL DESIGN

## PALAFOX ST & GARDEN ST/US 98 PENDING FDOT PERMIT



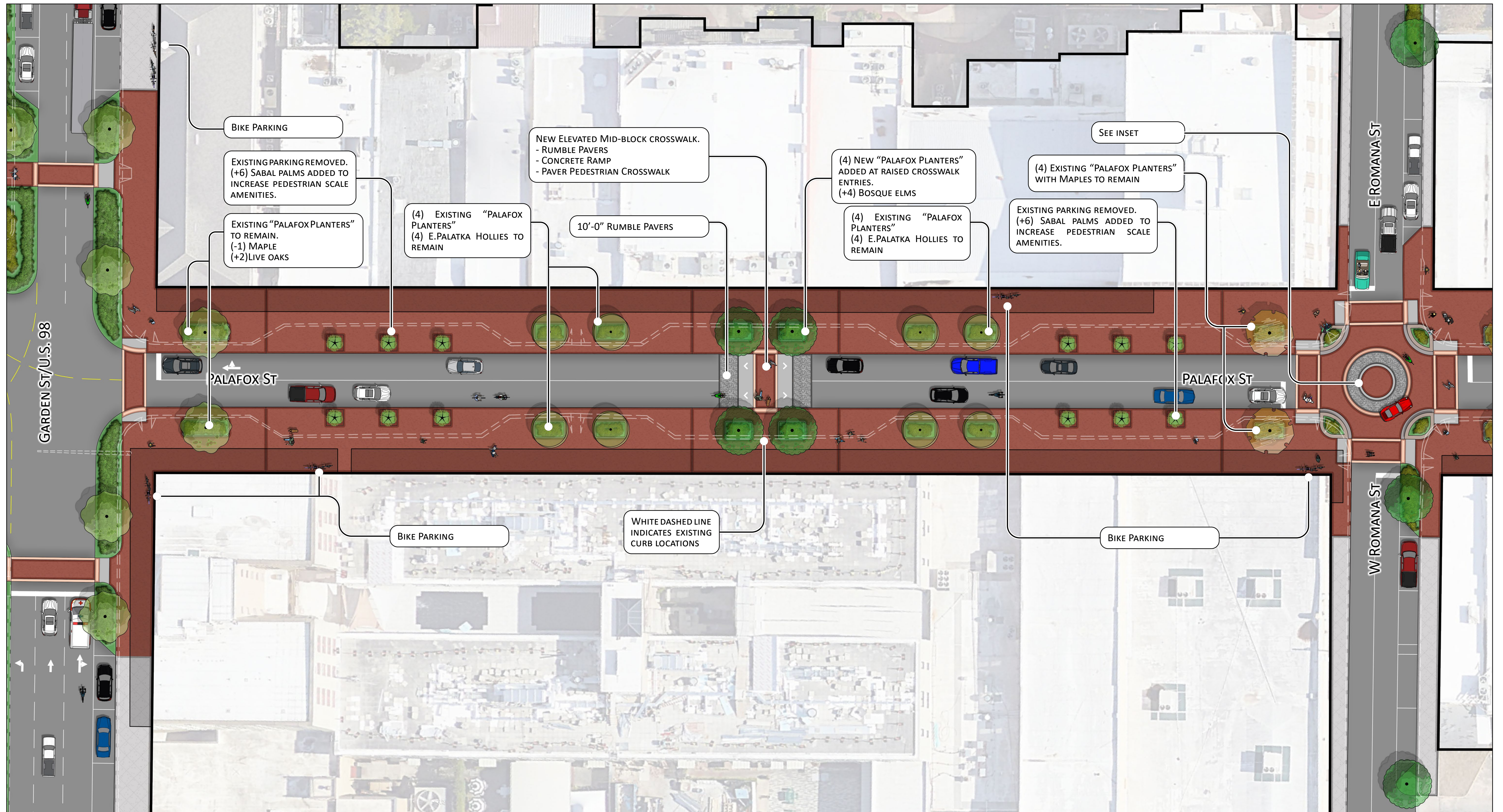

## PALAFOX ST - GARDEN ST TO ROMANA ST

### THE NEW PALAFOX - CONCEPTUAL DESIGN







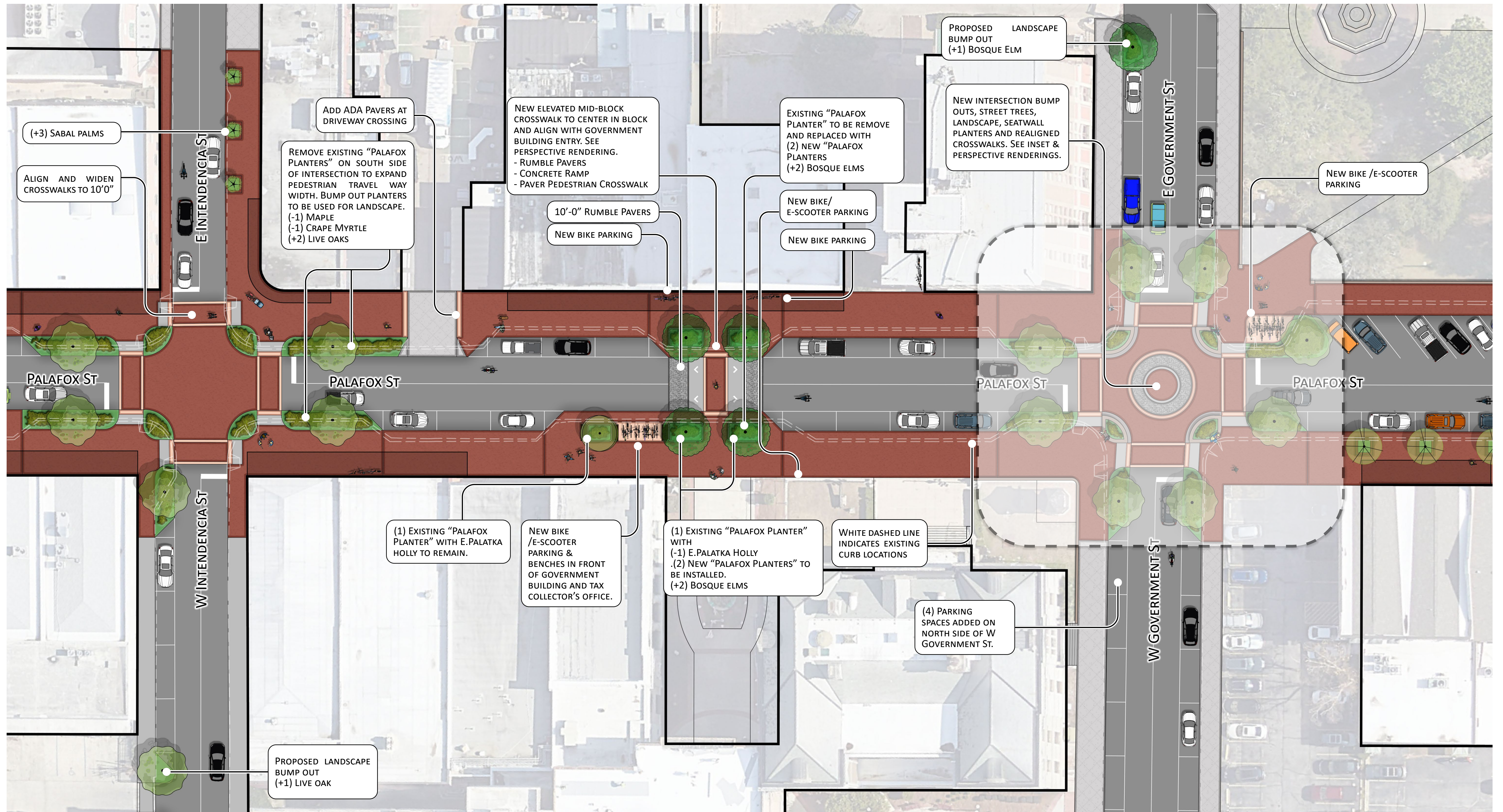

# PALAFOX ST - INTENDENCIA ST TO GOVERNMENT ST

## THE NEW PALAFOX - CONCEPTUAL DESIGN



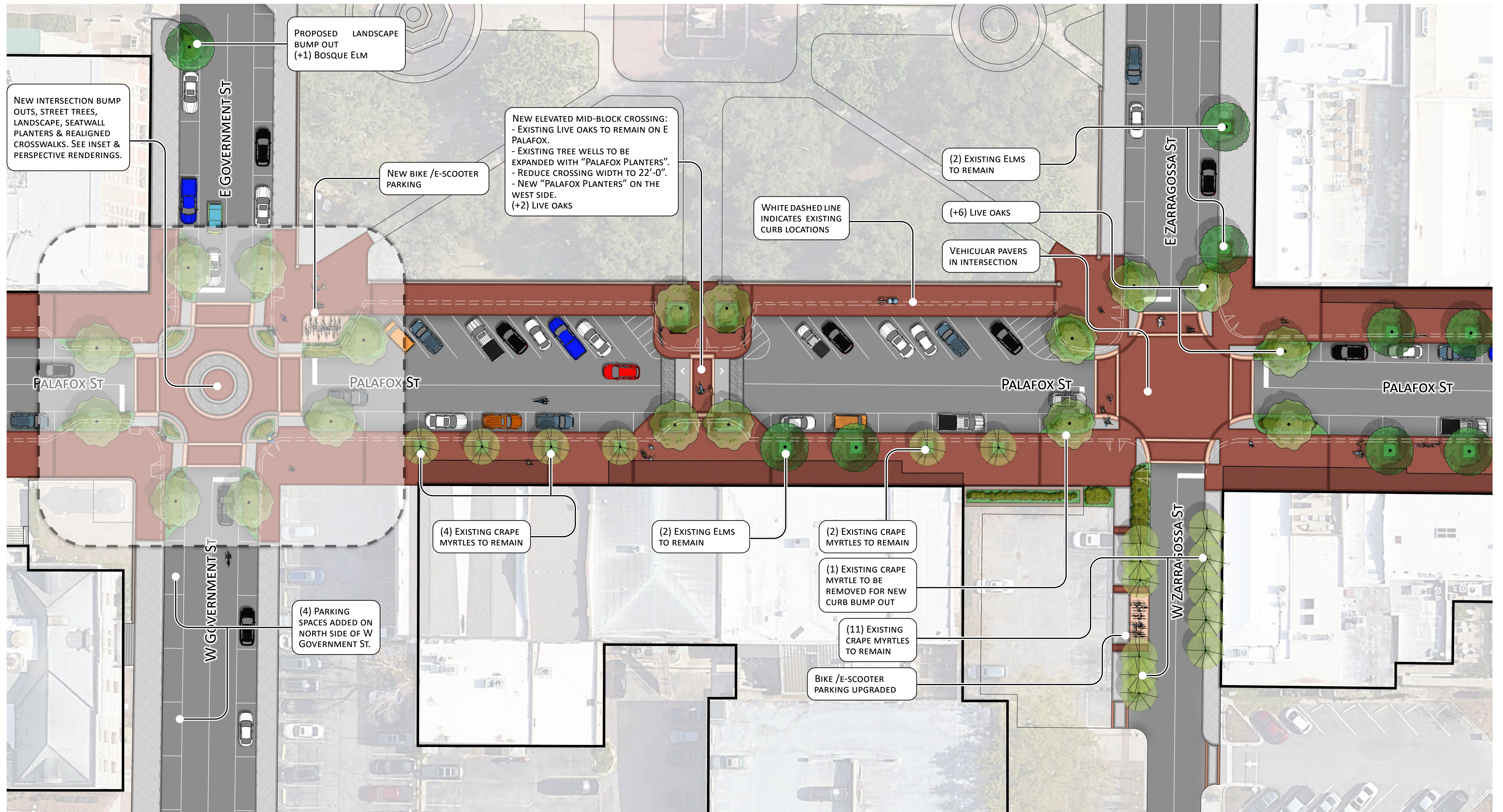

## PALAFOX ST - GOVERNMENT ST TO ZARRAGOSSA ST

### THE NEW PALAFOX - CONCEPTUAL DESIGN



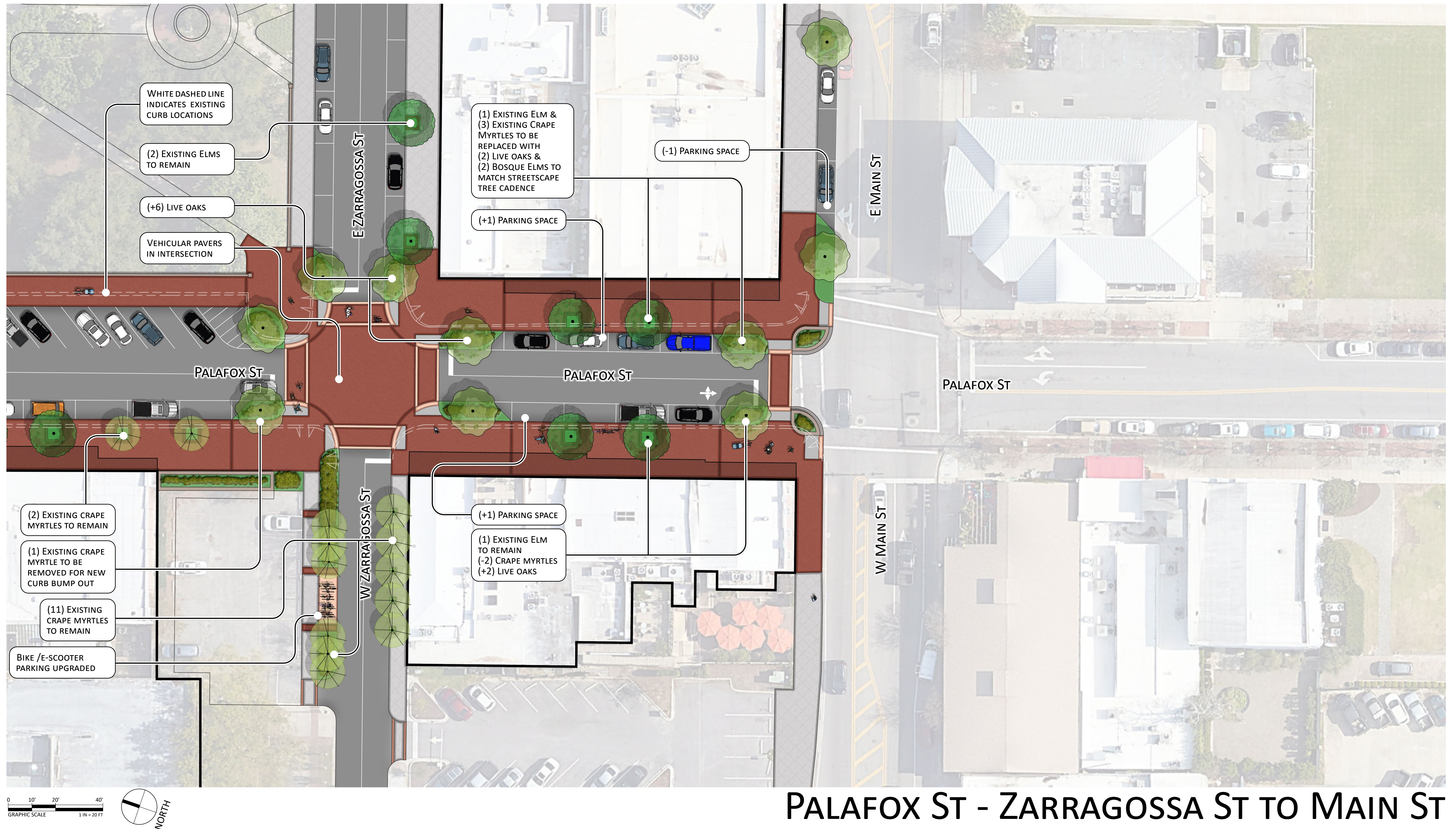

PALAFOX ST - ZARRAGOSSA ST TO MAIN ST

## THE NEW PALAFOX - CONCEPTUAL DESIGN



PALAFOX SPECIFIC RED  
PAVERS - VEHICULAR

PALAFOX SPECIFIC RED  
PAVERS - PEDESTRIAN

24" PAVER UTILITY STRIP  
ON BACK SIDE OF CURB

EXISTING CURB LINE  
TO BE MOVED

PROPOSED BIKE RACK/E SCOOTER  
PARKING

- REALIGN AND WIDEN CROSSWALKS  
TO 10'-0"  
- CROSSWALK SPECIFIC CONCRETE  
PAVER IN LIEU OF THERMOPLASTIC  
STRIPE PAINT

NEW LIVE OAKS AROUND  
INTERSECTION BUMP OUTS

BUMP OUTS AT INTERSECTION TO  
REDUCE PEDESTRIAN EXPOSURE  
TIMES WHEN CROSSING THE STREET.

18" HIGH PLANTER SEATWALL.  
CONCRETE CAP WITH GRANITE BALLAST  
STONE EXTERIOR. DECORATIVE  
RIBBON POINTING BETWEEN.

CENTER ISLAND:  
- 12" CONCRETE BAND TO VEHICULAR  
RUMBLE STRIP PAVERS ENCIRCLING  
VEHICULAR RATED PAVER DETAILING.  
  
- FORCE CARS TO SLOW DOWN AND  
MANEUVER THE INTERSECTION  
CAREFULLY WILL REDUCE PEDESTRIAN  
INJURY.

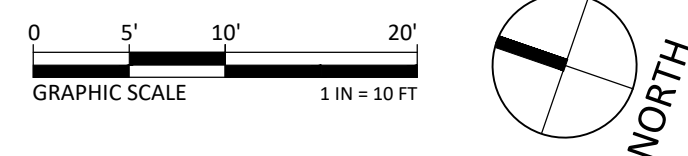

## INSET - PALAFOX ST & GOVERNMENT ST INTERSECTION

THE NEW PALAFOX - CONCEPTUAL DESIGN





### BALLAST STONE SEATWALLS AT INTERSECTIONS

EXISTING CONDITIONS EXIST AT PLAZA FERDINAND LOCATED AT EAST GOVERNMENT ST AND 309 S PALAFOX ST.



### PALAFOX BLEND PAVERS TO MATCH EXISTING CITY STANDARD "RED"

CITY TO DEFINE A STANDARD FOR ALL DEVELOPERS TO REFERENCE AND MATCH. USE PALAFOX AS A PILOT PROJECT TO DEFINE.



### RUMBLE STRIP PAVERS IN LIEU OF THERMOPLASTIC PAINT

WHERE NEEDED IN PAVEMENT DESIGNED DRIVE LANES, THERMOPLASTIC PAINT IS SUBSTITUTED FOR A HIGH CONTRAST RUMBLE PAVEMENT SUCH AS AN "OLD WORLD PAVEMENT" STOP BAR PICTURED ABOVE, LOCATED ON JEFFERSON ST.



### CONCRETE GRID

5'x5' DIAGONALLY SAW CUT PATTERNS WITHIN CONCRETE TO ADD TEXTURE AND DETAIL TO NON-PAVER, PEDESTRIAN LOCATIONS.



### ADA PAVERS AT VEHICULAR CROSSINGS

CITY TO DEFINE A STANDARD ADA COMPLIANT PAVEMENT FOR ALL DEVELOPERS TO REFERENCE AND MATCH. USE PALAFOX AS A PILOT PROJECT TO DEFINE.



### RUMBLE PAVERS

THE ADDITION OF RUMBLE PAVERS ADDS BEAUTY AS WELL AS SAFETY TO THE MID-BLOCK CROSSINGS. DRIVERS ARE ALERTED VISUALLY, AUDIBLY AND PHYSICALLY TO PEDESTRIAN TRAVEL ZONES.

## HARDSCAPE BUILDING BLOCKS

## MATERIALS & IMAGE BOARDS

### THE NEW PALAFOX - CONCEPTUAL DESIGN





## INTERSECTION PAVER DETAILING

CREATE A RADIAL PAVER DESIGN AND WARNING RUMBLE PAVERS CUING VEHICLES TO SLOW DOWN AND MANEUVER THE INTERSECTION CAREFULLY. THIS WILL PROMOTE PEDESTRIAN SAFETY WHILE CONTINUING TO BRING THE PEDESTRIAN STYLE PAVERS TO THE ROADWAY FOR AESTHETIC CONTINUITY.



## 'AMERICA'S FIRST SETTLEMENT TRAIL'

EMPHASIZE AND CEMENT THE TRAIL WITH A PAVER DETAIL AND BRASS EMBLEMS IN THE CITY RIGHT OF WAY.



## 'AMERICA'S FIRST SETTLEMENT TRAIL' - PAVER DETAIL EXAMPLE

CASE STUDY OF THE BOSTON FREEDOM TRAIL PAVER DETAIL. AMERICA'S FIRST SETTLEMENT TRAIL WILL UTILIZE GRANITE PAVERS TO DEFINE THE BORDER OF A SOLIDER COURSE RED PAVER. WHERE THE TRAIL TRAVERSES CONCRETE FLAT WORK THE GRANITE PAVER BORDER SHALL BE REMOVED.



## PEDESTRIAN RESPITE & SAFETY

UTILIZED PLANTER BOLLARDS AND LANDSCAPE TO DEFINE RESPITE OPPORTUNITIES FOR PEDESTRIANS.



## PEDESTRIAN RESPITE & SAFETY

PROPOSED LANDSCAPE AND VOIDS BETWEEN LANDSCAPE HELP DEFINE SPACES FOR OUTDOOR SEATING TO BE PROVIDED BY PROPERTY OWNERS.

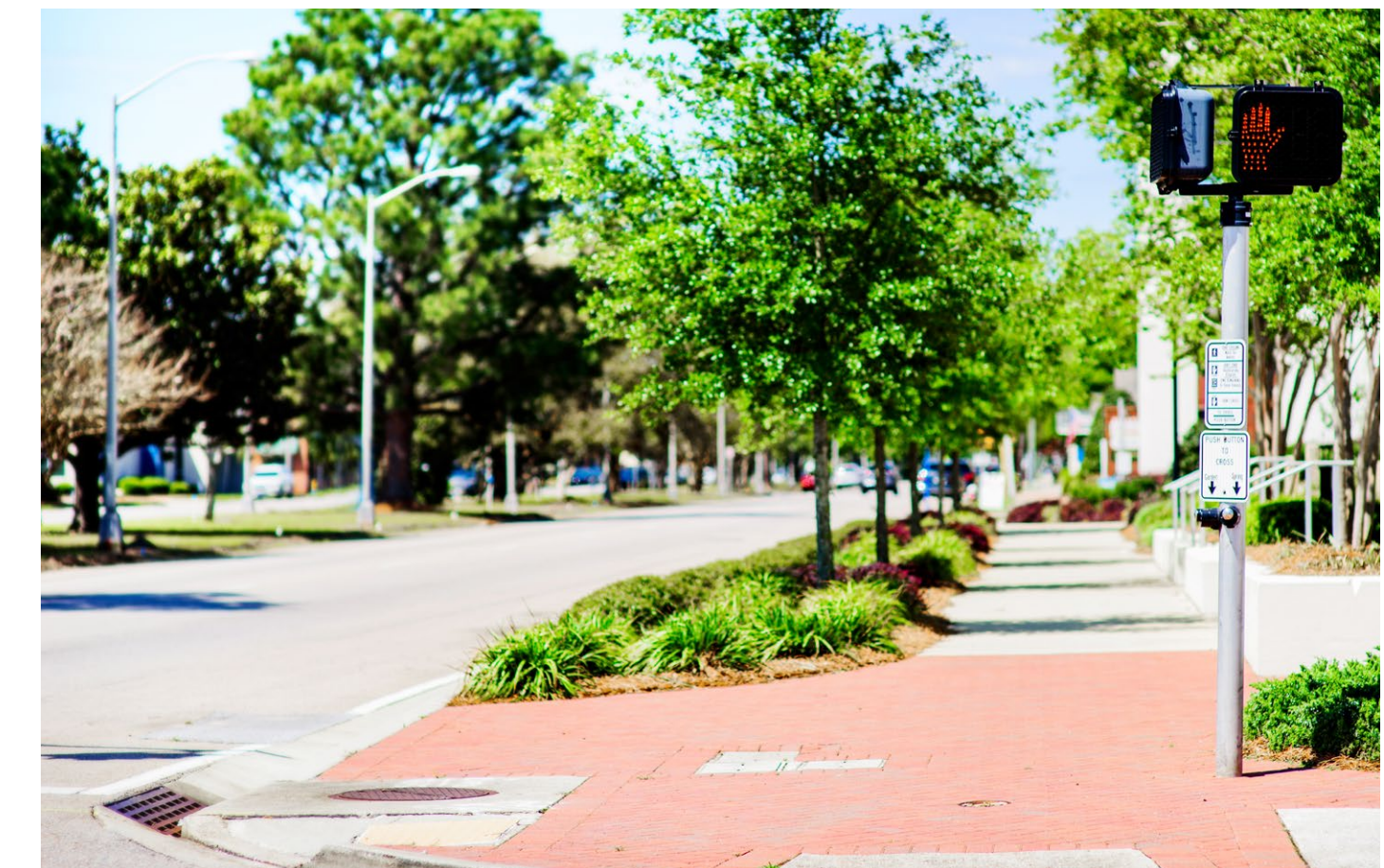

## BUMP OUT EXAMPLE

"BUMPED OUT" INTO THE ROADWAY TO ALLOW PLACEMENT OF STREET TREES WHILE REDUCING PEDESTRIAN EXPOSURE AND INCREASING TREE CANOPY COVERAGE ALONG PALAFOX

# PLACES & SPACES

## THE NEW PALAFOX - CONCEPTUAL DESIGN

# MATERIALS & IMAGE BOARDS



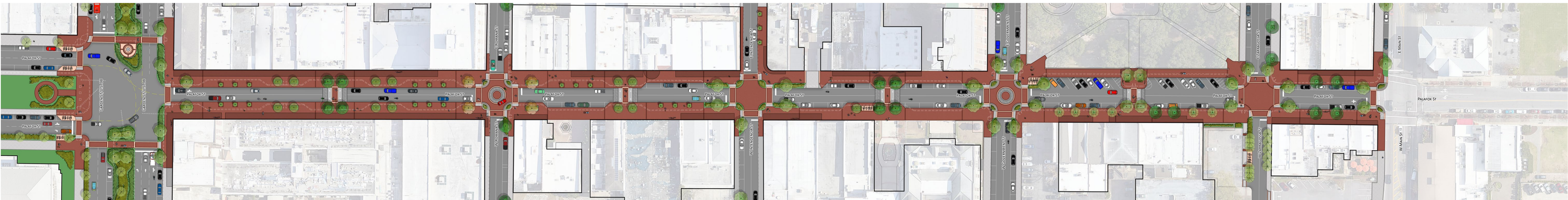

TREE SCHEDULE

SYMBOL CODE QTY BOTANICAL / COMMON NAME SIZE

TREES

	QV	36	QUERCUS VIRGINIANA SOUTHERN LIVE OAK	3" DBH
	SS	21	SABAL PALMETTO CABBAGE PALMETTO	18` CT
	UB	15	ULMUS PARVIFOLIA 'BOSQUE' BOSQUE® LACEBARK ELM	3" DBH

EXISTING TO REMAIN

	ERM	4	ACER RUBRUM RED MAPLE	VARIES
	EAR	13	ILEX X ATTENUATA EAST PALATKA HOLLY	VARIES
	ELI	33	LAGERSTROEMIA INDICA CAPE MYRTLE	VARIES
	EQV	2	QUERCUS VIRGINIANA SOUTHERN LIVE OAK	VARIES
	EUB	5	ULMUS PARVIFOLIA 'BOSQUE' BOSQUE® LACEBARK ELM	VARIES

BY THE NUMBERS

EXISTING PARKING SPACES IN SCOPE.....	149 SPACES
PROPOSED PARKING SPACES IN SCOPE.....	146 SPACES
NET LOSS .....	- 3 SPACES

EXISTING PERVIOUS SURFACE.....	4,188 SQ FT
PROPOSED PERVIOUS SURFACE.....	16,510 SQ FT
NET GAIN .....	+12,322 SQ FT

EXISTING CANOPY TREES.....	57
PROPOSED CANOPY TREES.....	108
NET GAIN .....	+ 51 TREES